

**Assembly instructions for Meyra Type 1,750
MEM6151 and MEM6152**

1. Remember to assemble the wheelchairs original anti tip devices.
2. Remove wheels and hub sleeves on both side of the wheelchair.

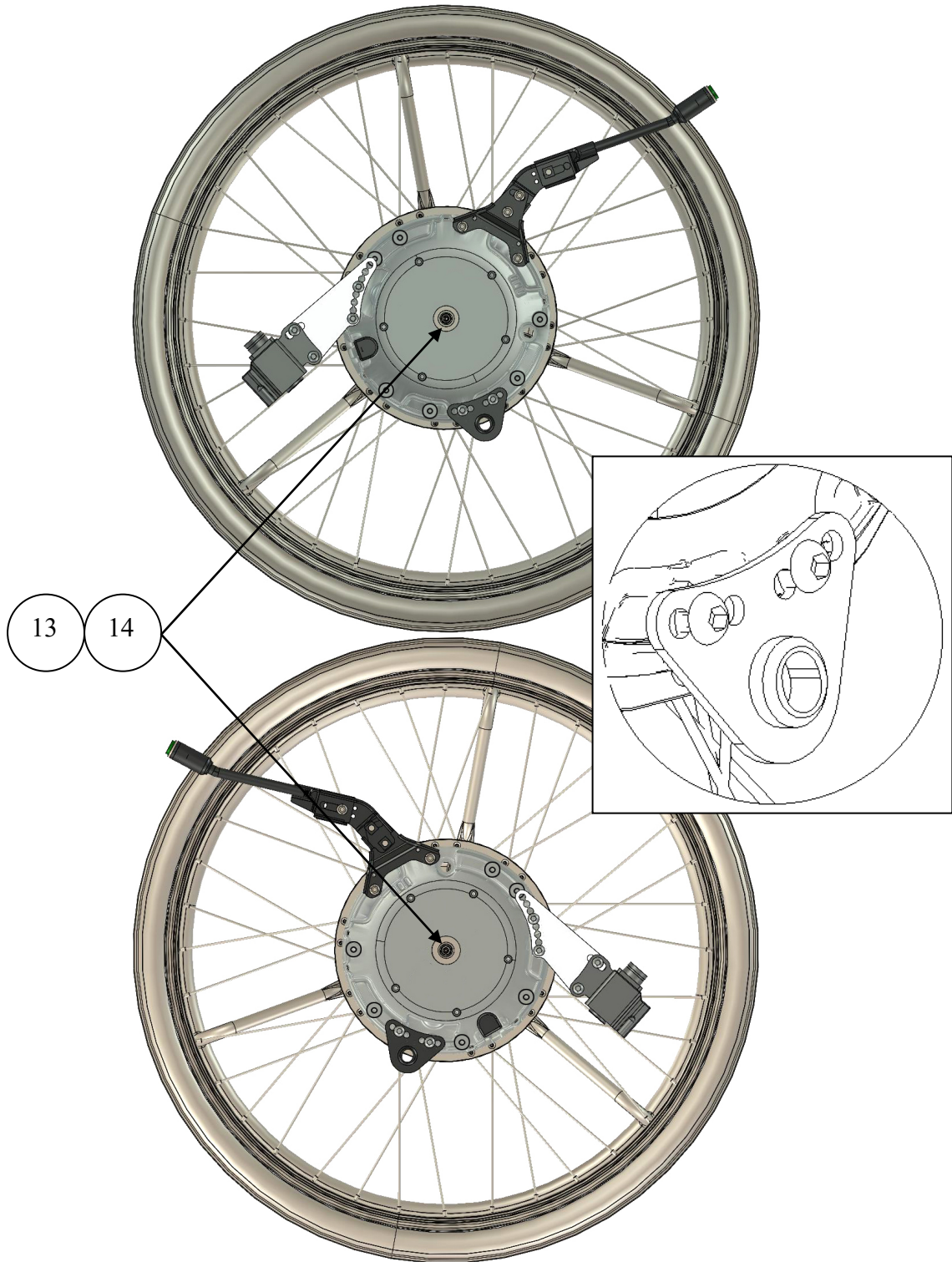

3. Check the correct placement for the eMove, and that it is axle $\varnothing 12,0 \times 51$ with Part Number: XOE-2530-BO and Spacer with Part Number: XOE-25383-00.

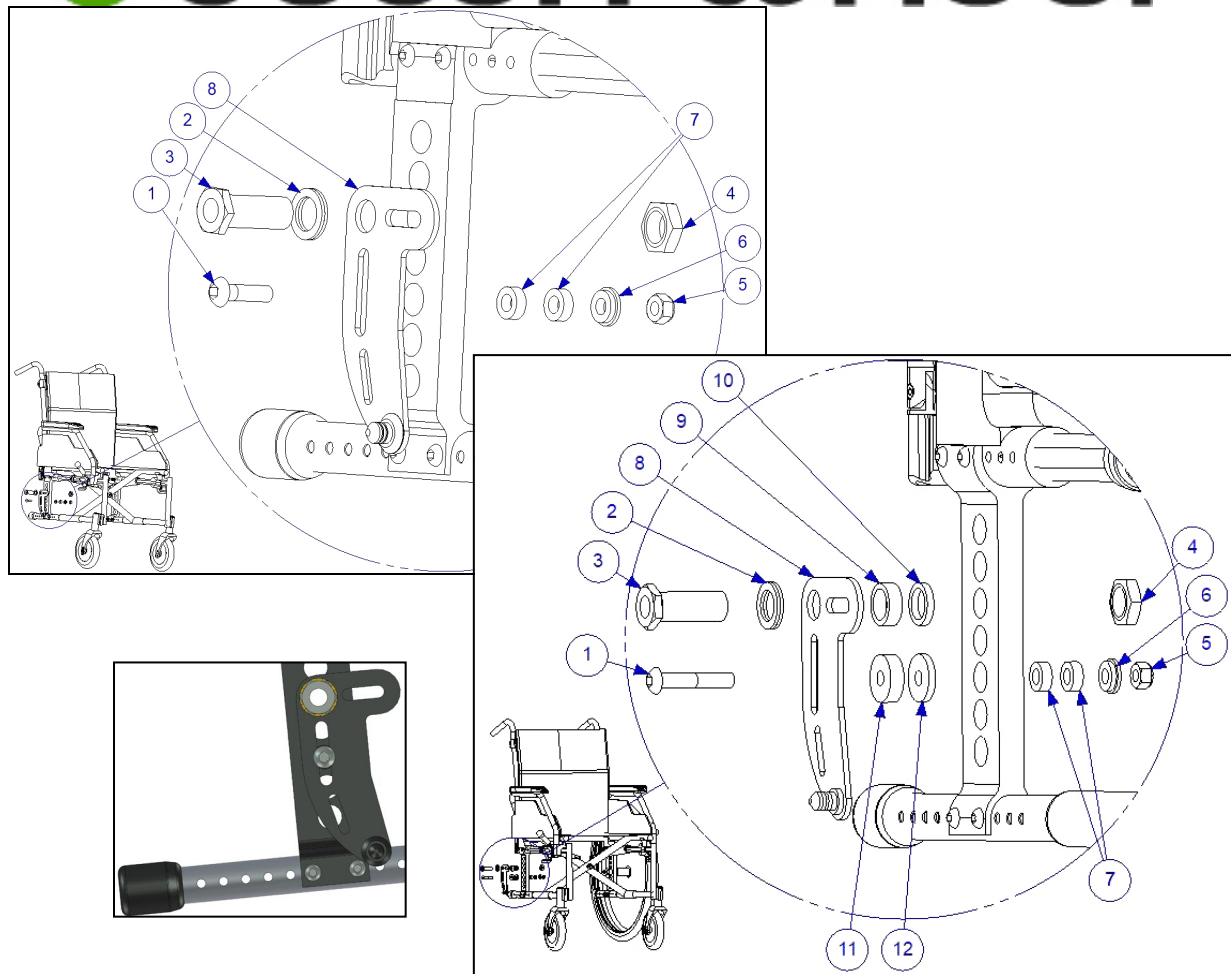

4. Assemble the bracket according to pictures on top. Add/remove spacers (9-12) depending of what type of adapter plate and what placement it is.

Parts for right side mounting:

Item No.	Part Number	Qty	Description
1	XSM8X45	1	Screw Rounded M8 x 45
2	405239	1	Nordlock Washer M16
3	HW063	1	Sleeve M16x1/12,0
4	XSM16M	1	Nut M16X1 Low
5	XSM8ML	1	Lock Nut M8
6	100 400 007	1	Spacer
7	100 400 002	2	Spacer
8	XOE-22294-BO	1	Right Bracket
9	100 400 006	1	Spacer
10	100 400 004	1	Spacer
11	100 400 013	1	Spacer
12	100 400 011	1	Spacer
13	XOE-25383-00	1	Spacer
14	93440-120520	1	Circlip

Note! If you only order the mounting set, the axle, axle spacer and the circlip **are not included**, for replacement see the service manual.

5. Assemble the back placed battery bag.