

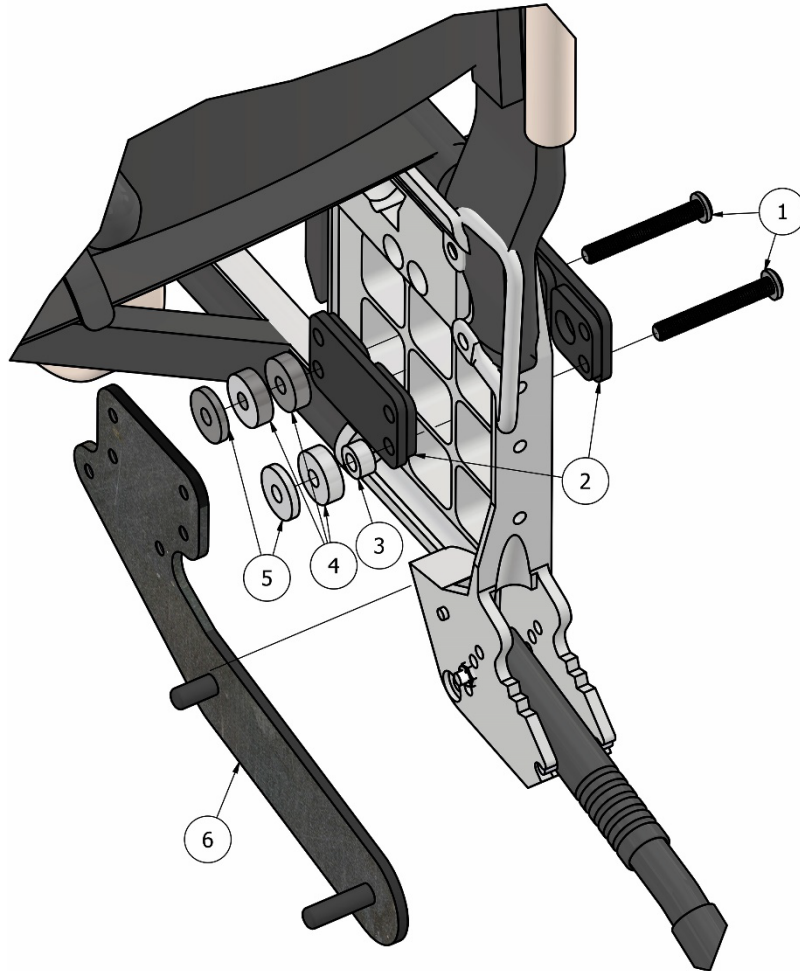

MCG1171_SB35

1. Remove wheels on both sides.
2. Remove hub with brakes on both sides.



2. Now install the bracket (see pictures above) picture are showing mounting of the bracket on the right side. For assembly on one side, the following must be included.

Item	Part Number	Qty	Description
1	XSM8X60	2	Screw M8x60
2	MCG1171-07	2	Bracket
3	100 400 003	1	Spacer 8mm
4	100 400 013	3	Spacer 8mm
4	100 400 011	2	Spacer 4mm
6	MCG1171_SB35R	1	Mounting bracket R Cross5_SW35

1. Assembly the bracket on the other side.
2. Assembly the hub with brakes and wheel

It is possible to fit wheels with size 22", 24" and 26". The bracket must be positioned correctly to match the height of the chair relative to the ground. Pictures below shows the screws location for different wheel sizes.

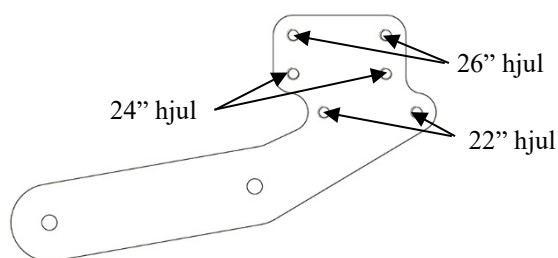

Optimal angle for E-Walk on Cross5



NOTE! Be sure to mount the screws in line with the hub center. The following example shows mounting with 22", 24" and 26" wheels. Note that the two M8 screws connecting the mounting plate to the E-walker with the chair must always be mounted in a horizontal line with the wheel axle. The pictures show the wheels in its middle position, both the lower and upper row can be used. See arrow to the right of the pictures.

Placement of the mounting bracket when assembled with 22" wheels.

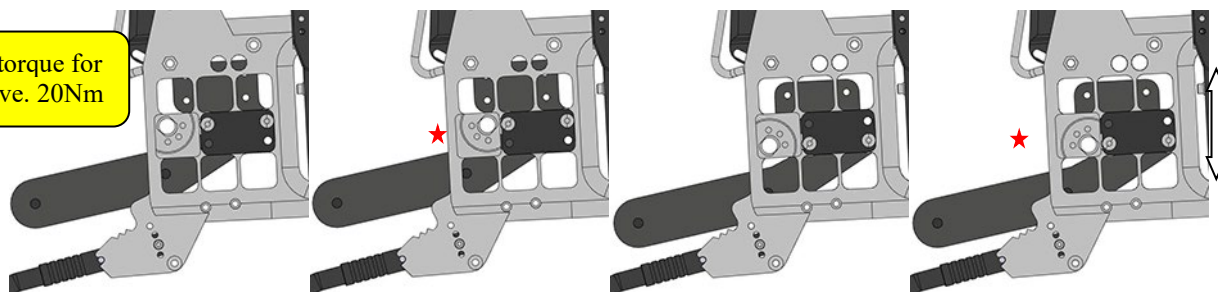

Placement of the mounting bracket when assembled with 24" wheels.

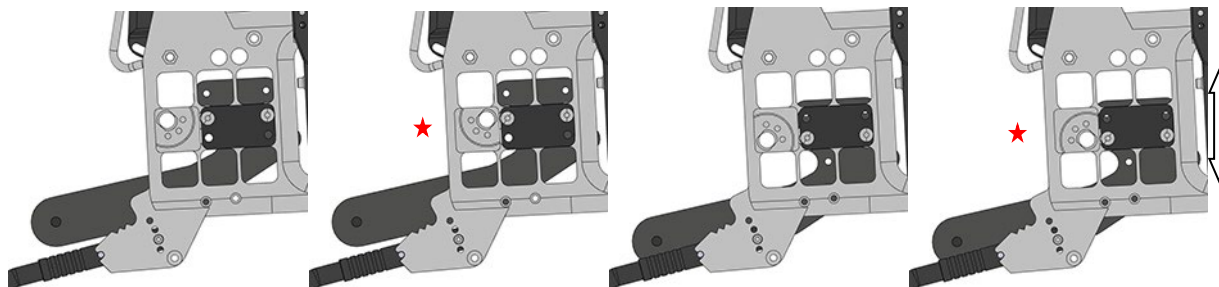

Placement of the mounting bracket when assembled with 26" wheels.

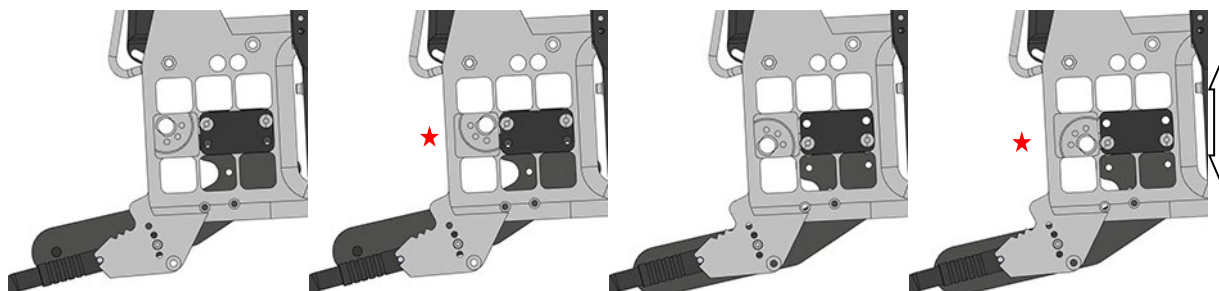

★ Hub sleeve is not possible to mount in these positions.

**Om inget annat specificeras, använd följande åtdragningsmoment.
Unless otherwise specified, use the following tightening torque.**

Metrisk grovgängor, stål.
Metric coarse threads, steel.

<i>Gänga / Thread</i>	<i>Åtdragningsmoment / Tightening torque</i>
M3	1,2 Nm
M4	3 Nm
M5	6 Nm
M6	10 Nm
M8	25 Nm
M10	50 Nm
M12	85 Nm