

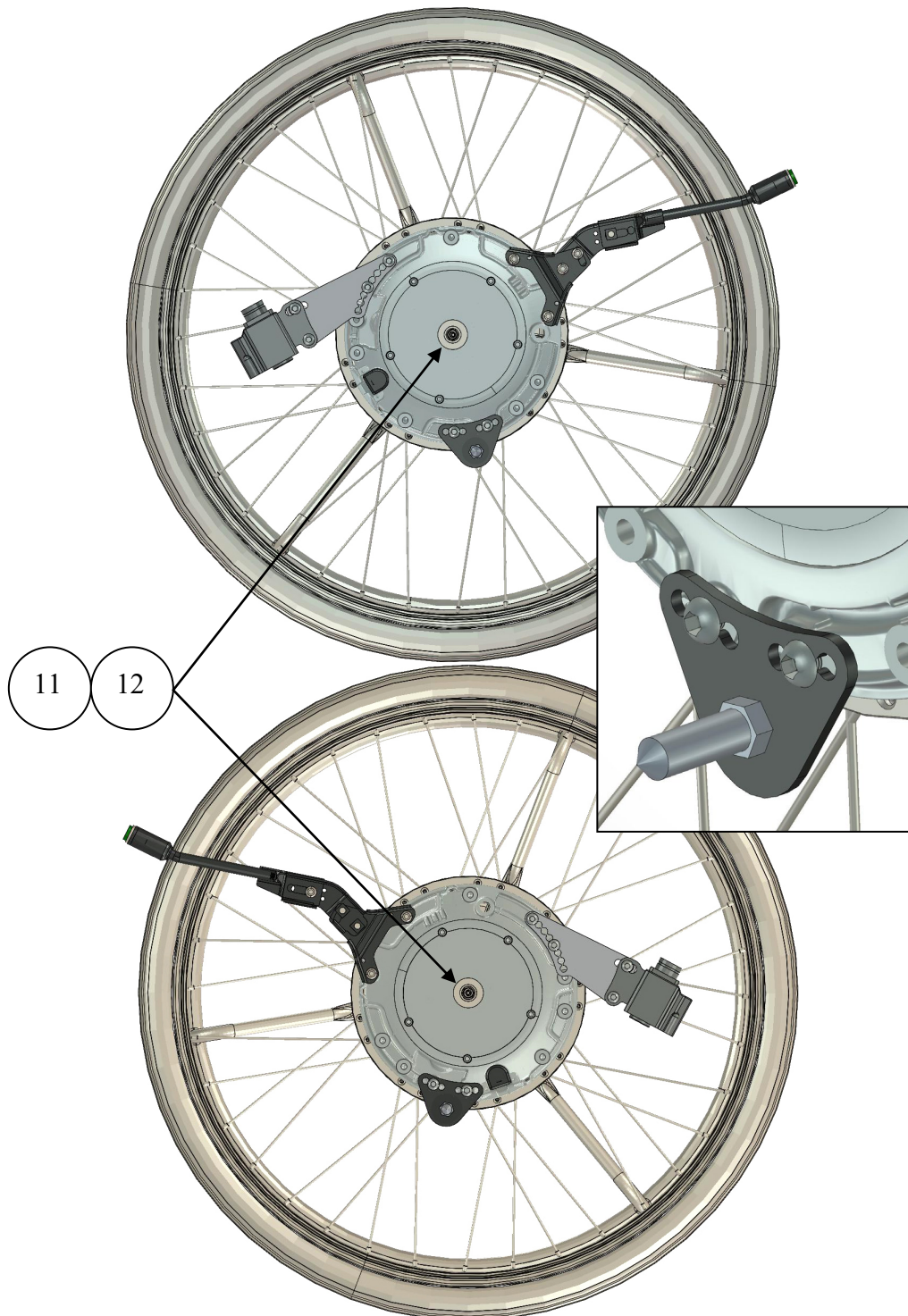

## Assembly instructions for Netti 4U with 24" wheel

### MEM6197P and MEM6198P

1. Remove wheels and brakes.



2. Check the correct placement for the eMove, and that it is axle  $\varnothing 12,0 \times 51$  with Part Number: XOE-2530E-BO and Spacer with Part Number: XOE-25383-00 and Stop pins are assembled with Part Numbers: 290000, 300001 and XSM8ML.

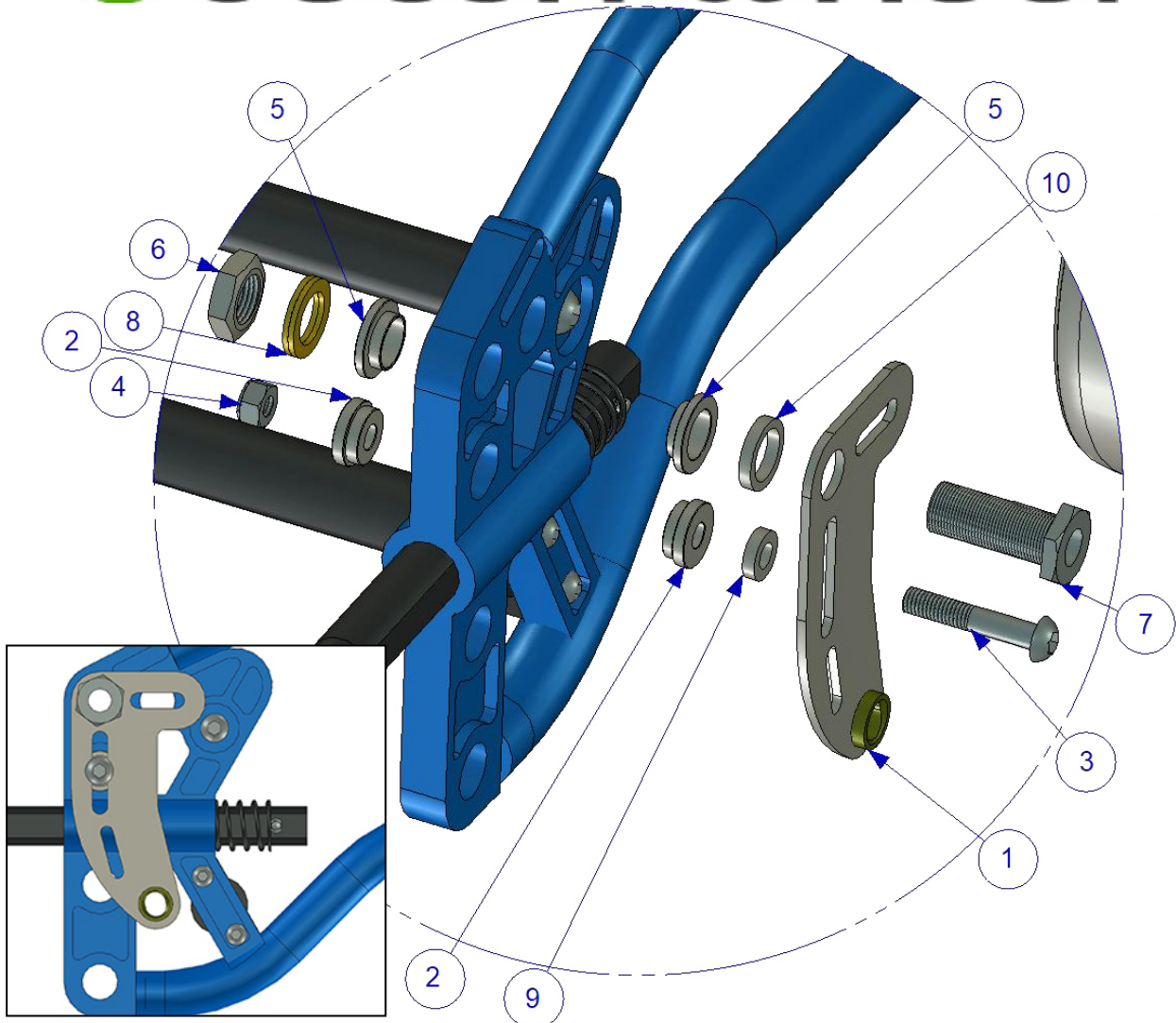

3. Assembly the plates according to pictures.

Parts for right side mounting:

Item No.	Part Number	Qty	Description
1	310022	1	Bracket
2	100 400 008	2	Spacer
3	XSM8X45	1	Screw Round M8 x 45
4	XSM8ML	1	Nut Self-Locking M8
5	100 400 009	2	Spacer
6	XSM16M	1	Nut M16X1 Low
7	HW063	1	Hub sleeve
8	405239	1	Nordlock Washer M16
9	100 400 001	1	Spacer
10	100 400 004	1	Spacer
11	XOE-25383-00	1	Spacer
12	93440-120520	1	Circlip

**Note!** If you only order the mounting set, the axle, axle spacer and the circlip **are not included**, for replacement see the service manual.

4. Assemble the back placed battery bag.