



Assembly Instructions

ADV5313, ADV5013, ADV5113

Adventus adaptor bar
Etac Cross 6

1. Safety

Symbols



Warning!

Risk of serious injury or death.

An operation that, if not correctly performed, may lead to injury to the operator or others.



CAUTION!

Risk of material damage.

An operation that, if not correctly performed, may lead to material damage.



INFO

Particularly important or explanatory information

General instructions

These instructions shall always be followed when placing the adaptor bar ADV5313, ADV5013, ADV5113 on a wheelchair.

Adjustment of the Adventus wheel is described in the user manual of the Adventus wheel.

Warnings



WARNING!

Assembly work or changes made to the mounting set must be carried out by trained service technician, reseller or another person assigned by Decon.

2. Overview

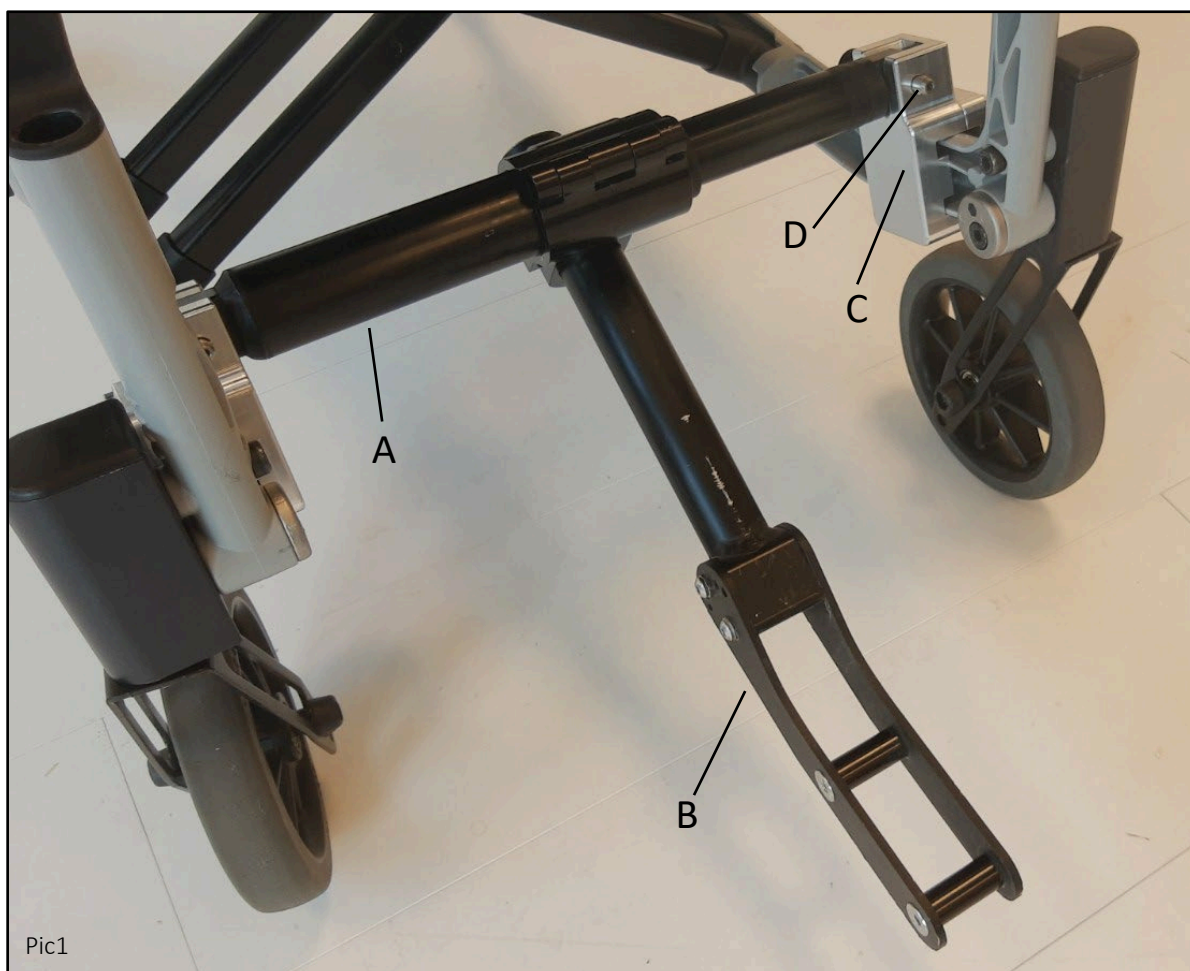

INFO

Picture above (Pic1) show a Cross 6 wheelchair.

A Adapterbar

B Fork adapterbar

C Adapterkit

D QR Pin

3. Assembly adapterkit

First mount the Adapterkit (C) on both sides of the frame. The pictures bellow (Pic2, Pic3, Pic4) show one side only. Tighten the screws **crosswise** (Pic4).

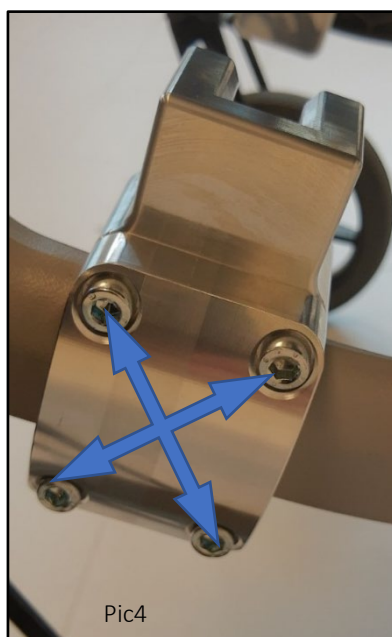
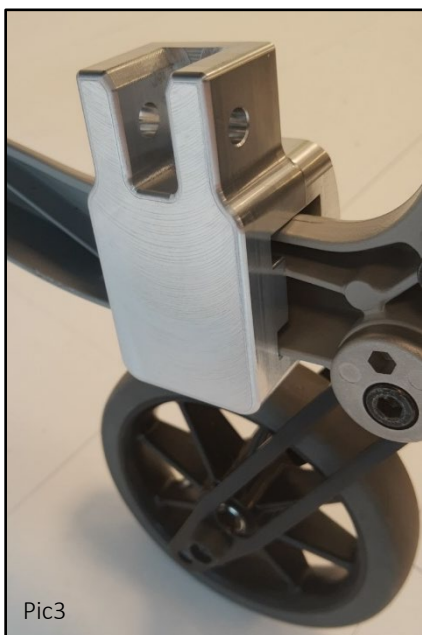
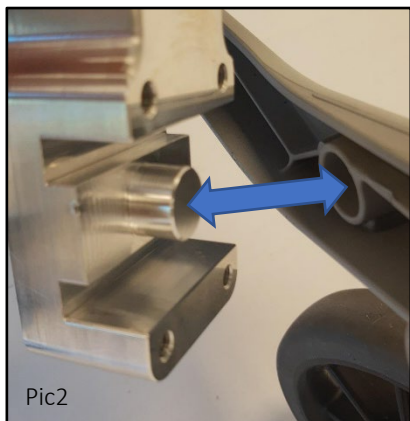

The round part of the adapterkit shall be fitted inside the hole of the wheelchair frame.



The screws holding the clamps (G) shall be tightened to 8-10Nm. Loctite 243 or eq. must be applied.

4. Adjustment of the adaptor bar

Mount the adapterbar (A) and fork (B) to the adapterkit (C) using the QR-Axle (D)

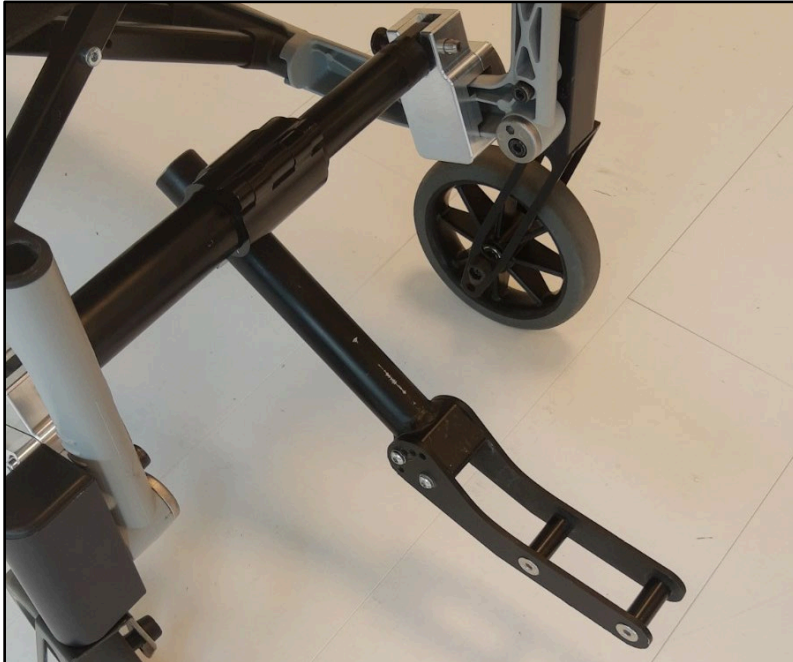

Mount the adjustment toll onto the fork (B). Remove the screws in the fork that locks the rotation (see picture bellow). Also make sure that the fork sits in the center of the wheelchair.

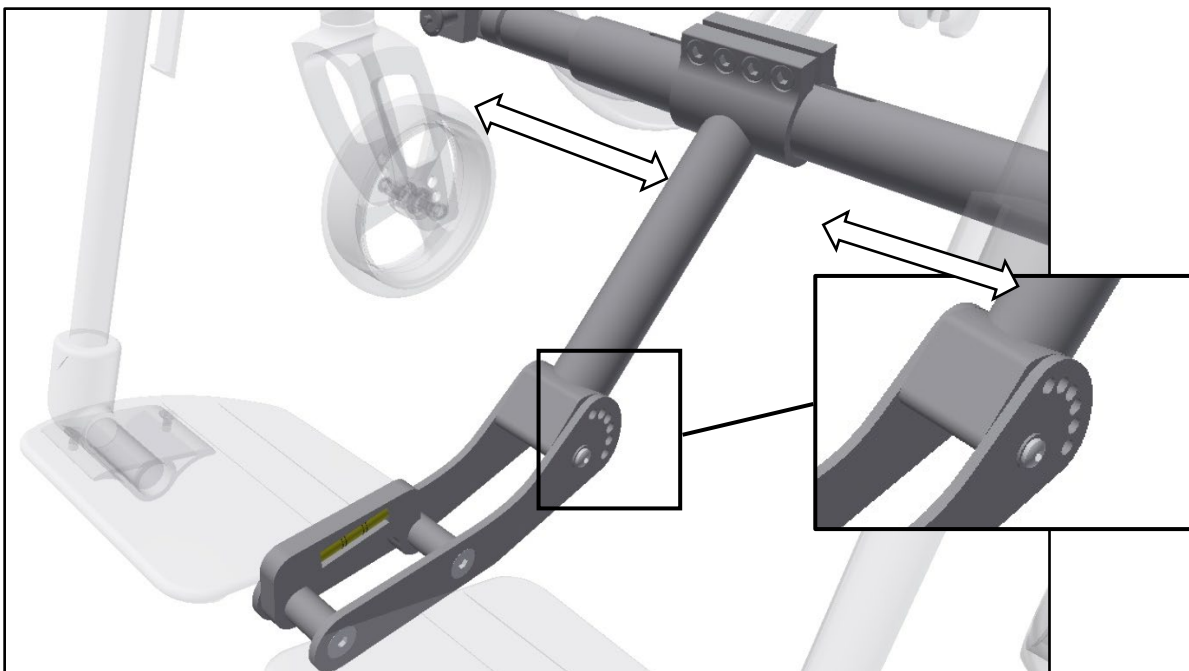

Now rotate both the adapter bar and the fork to a position where the adjustment tool shows the correct angle and the fork doesn't collide with the footrests. If possible, make sure that the fork doesn't sit lower than the footrest and that the height, if possible, corresponds to the picture below.

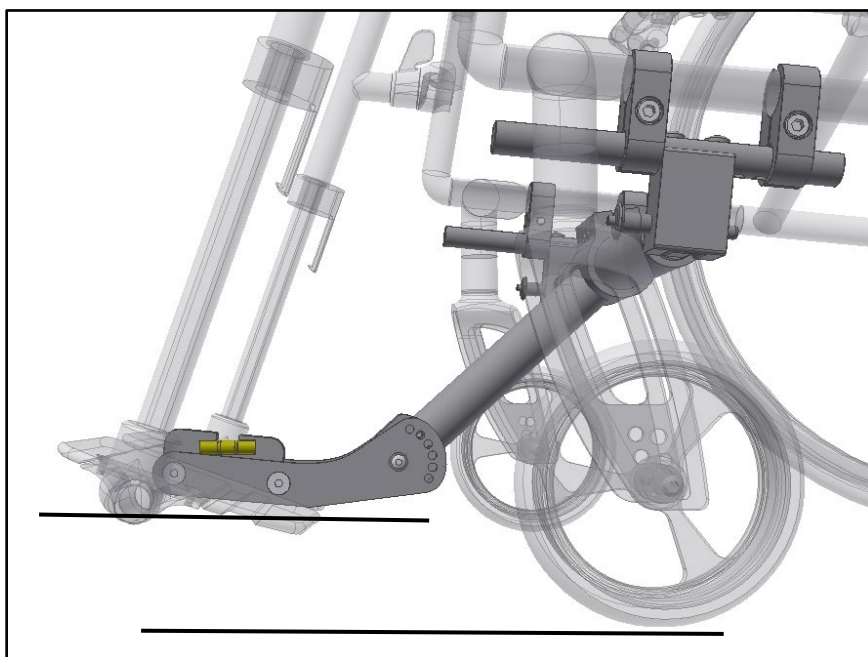

Reassemble the screw in the hole that is fits the best, see picture bellow for example.

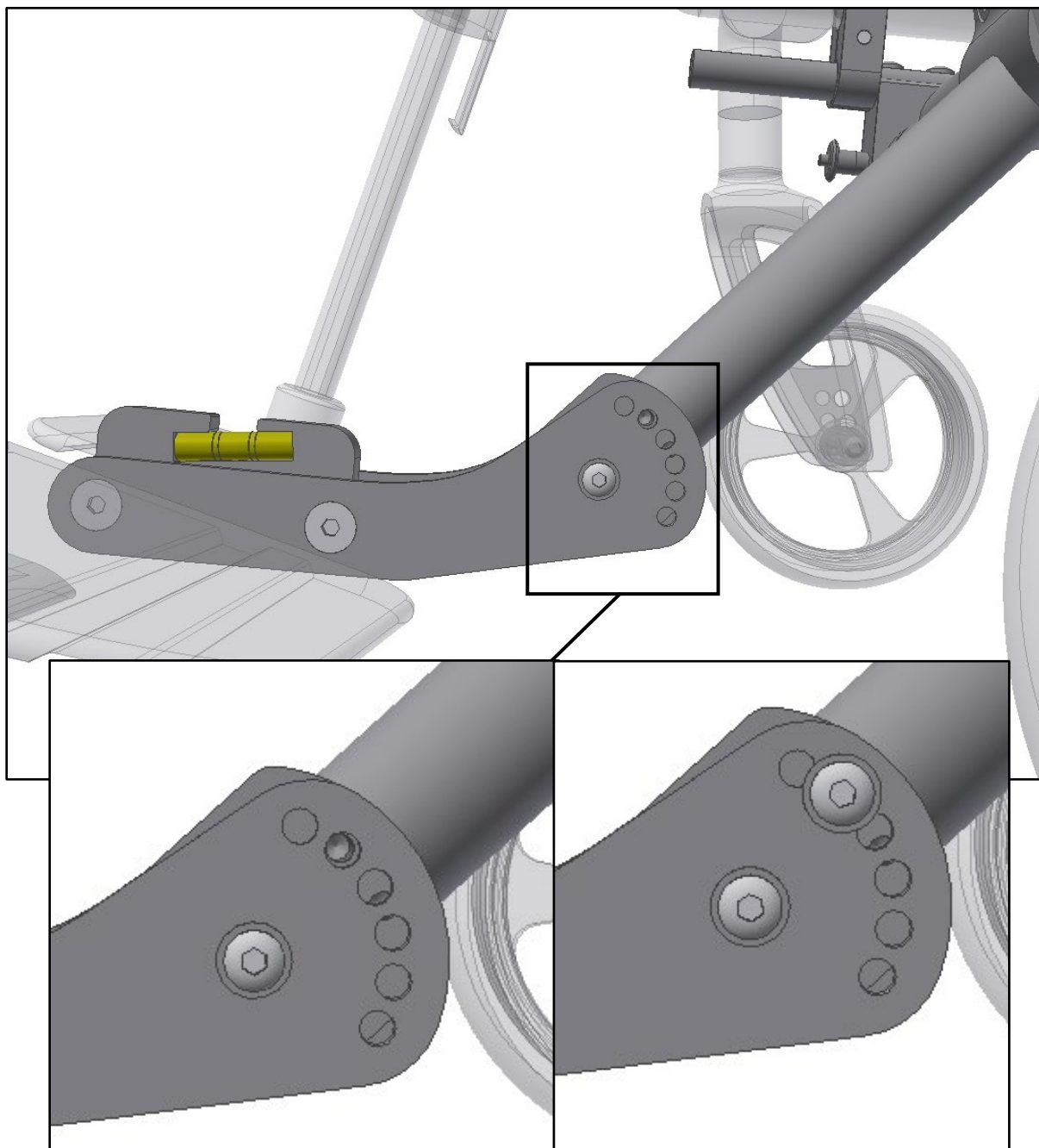

Now tighten the screws that sits in the clamp of the adaptor bar. Slightly tighten all four screws on the clamp. It is important to not completely tighten each screw, but to slowly tighten all four, a little at a time. **Keep tightening until all four screws are secured (30-35Nm of torque).** Also make sure one last time that the fork is centered and the angle of the adjustment tool is still correct.

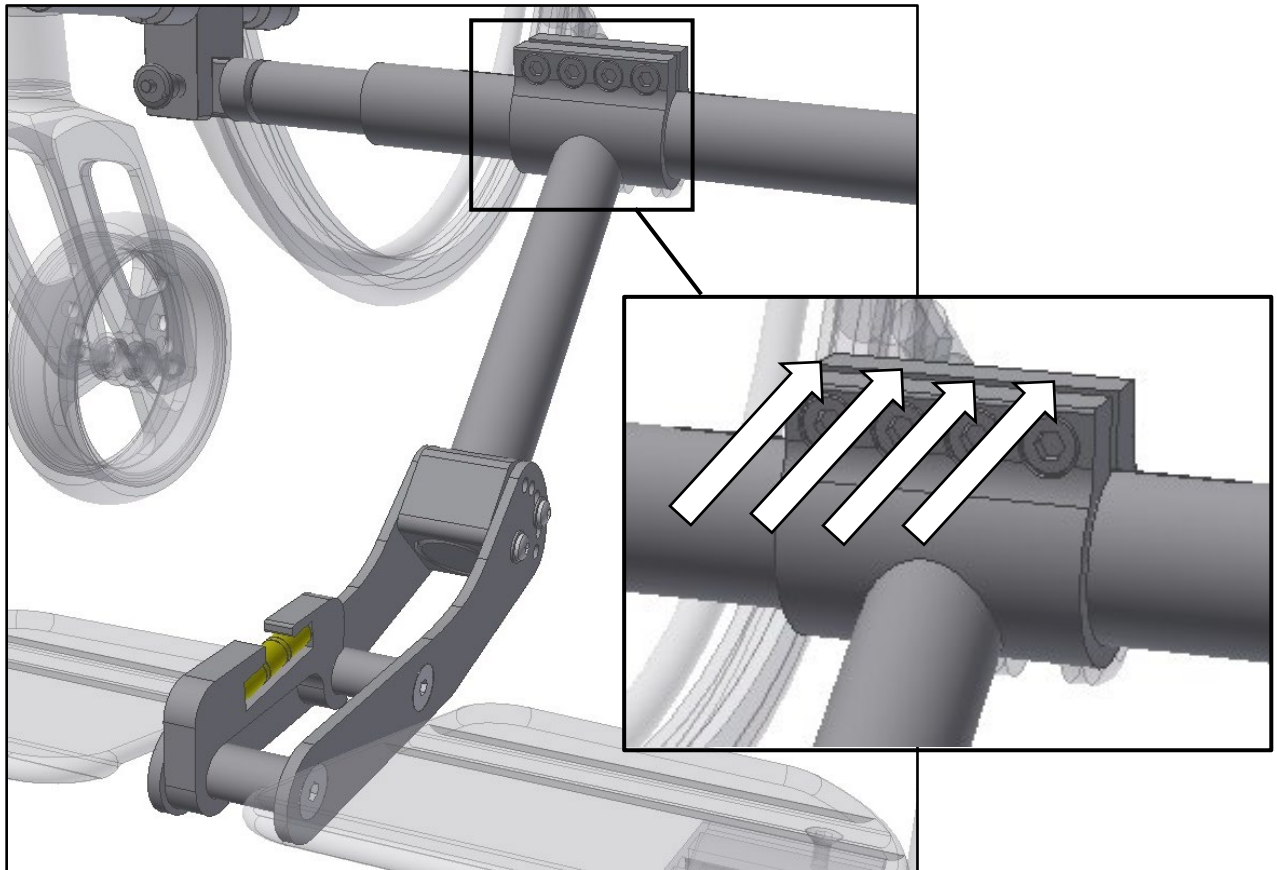

Check one last time that all screws are properly secured. Now see the user manual of Adventus to continue the installation. This can be downloaded from www.decon.se/en/

Decon Wheel AB
Södra Ekeryd 119, SE-314 93 Hyltebruk, Sweden
Tel: +46 (0)345 40880
Fax: +46 (0)345 40895
E-mail: info@decon.se

