

# decon wheel

Assembly instructions for GTM Hammer Vario  
MED3144

1. Remove wheels, sleeves and nuts.

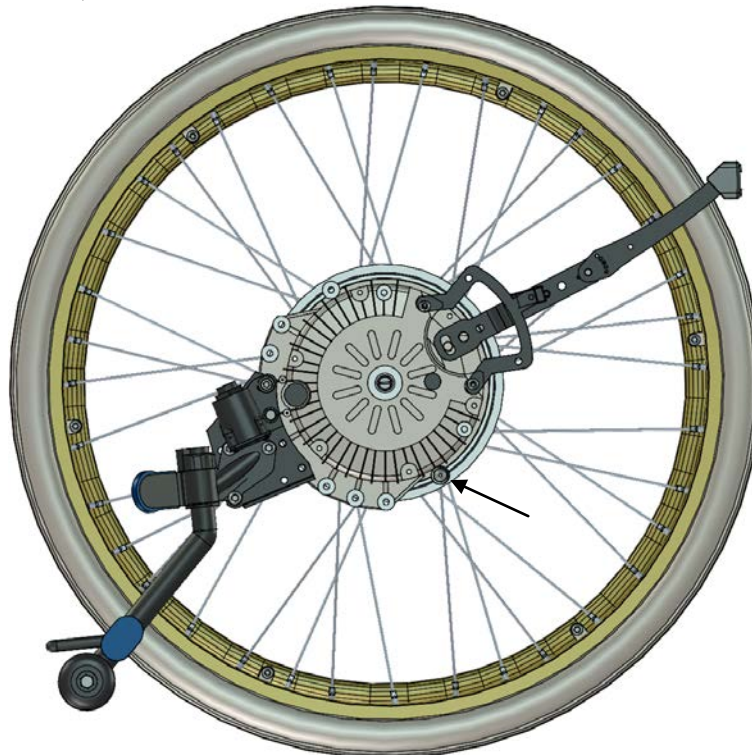

2. Check the correct placement for the stop pin and that the battery box is removed.

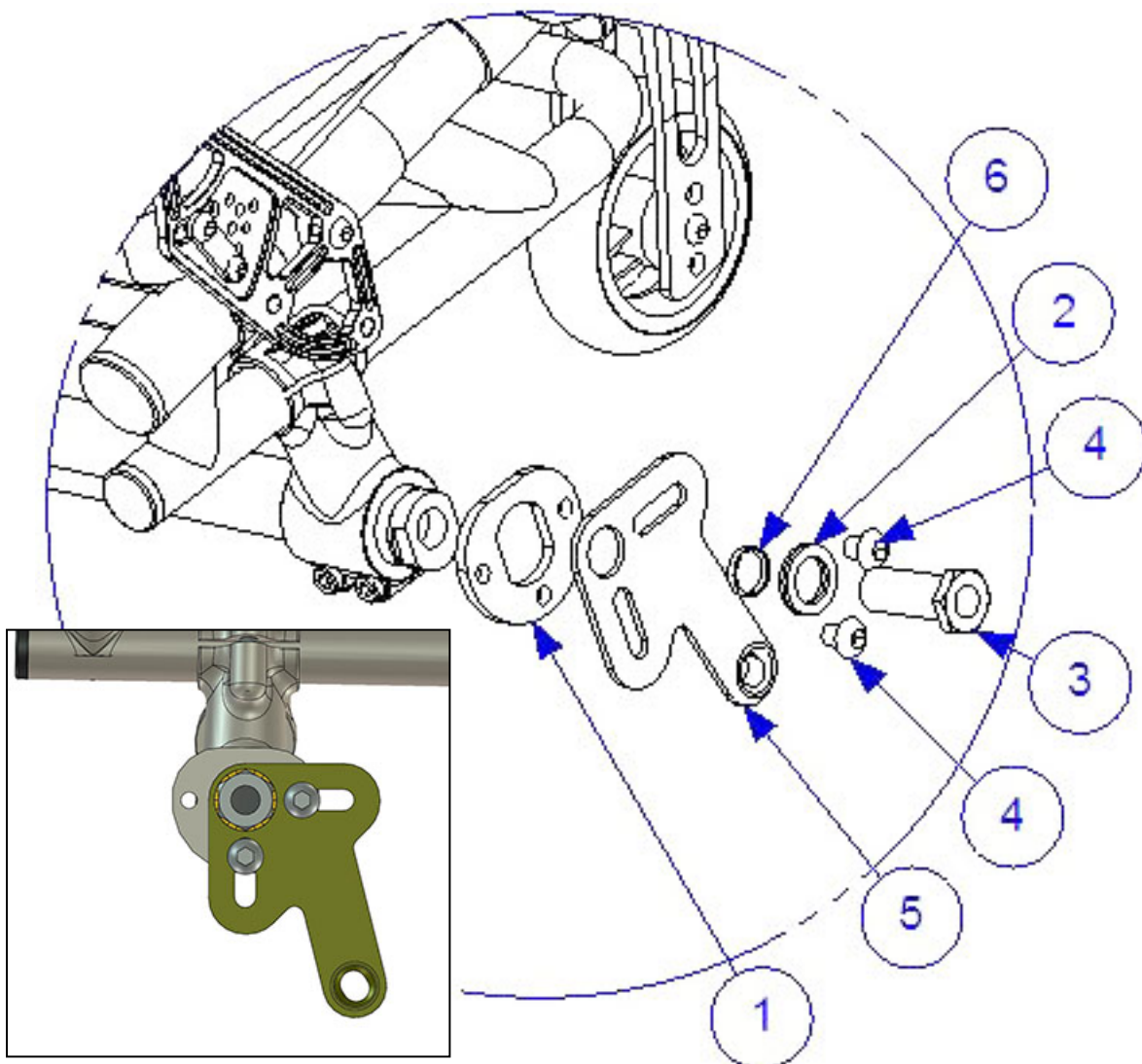

3. Assembly the plate (right side) according to picture.

Parts pair mounting set for right side:

Item No.	Part Number	Qty	Description
1	300128	1	Bracket GTM
2	405239	1	Nordlock Washer M16
3	HW069	1	Sleeve
4	XSM8X10	2	Screw : Round - M8,0 x 10,0
5	MED2000	1	Bracket
6	100 400 017	1	Spacer

4. Assemble the under placed battery bag.