



Assembly Instructions

Adventus Footrest
Universal

2023-10-03
Revision 1



1. Safety

Symbols



Warning!

Risk of serious injury or death.

An operation that, if not correctly performed, may lead to injury to the operator or others.



CAUTION!

Risk of material damage.

An operation that, if not correctly performed, may lead to material damage.



INFO

Particularly important or explanatory information

General instructions

These instructions shall always be followed when placing the mounting ADV5 Adventus adaptor bar universal on a wheelchair.

Adjustment of the Adventus wheel is described in the user manual of the Adventus wheel.

Warnings



WARNING!

Assembly work or changes made to the mounting set must be carried out by trained service technician, reseller or another person assigned by Decon.

2. Overview

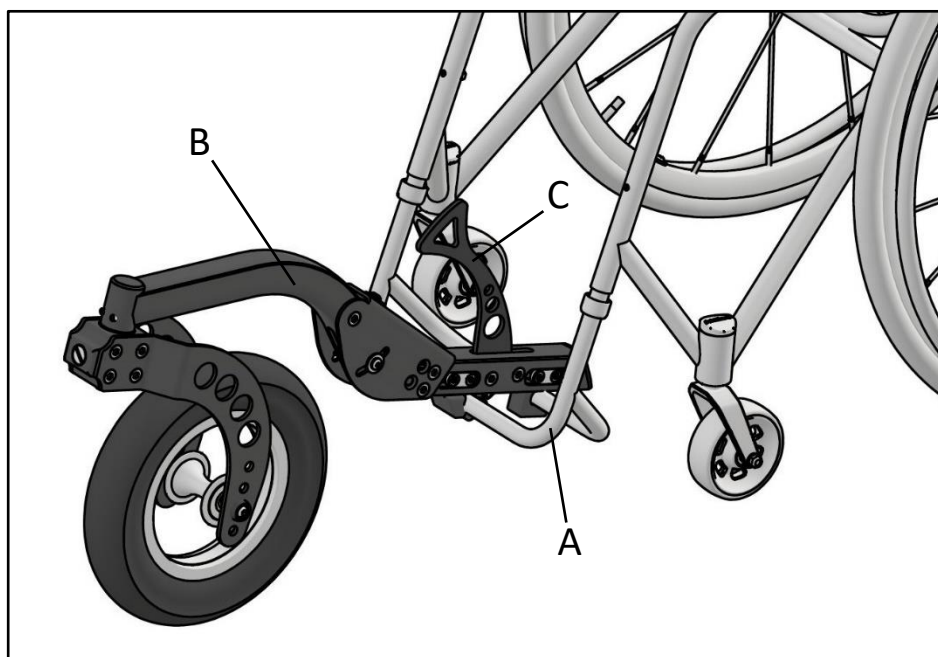

A Footrest

B Adventus

C Lock lever



These assembly instructions show a general assembly on wheelchairs with footrest made of round tubes, where the Adventus can be attached directly to the wheelchair's footrest.

3. Assembly adapterkit

Adjustment and settings are described in the user manual for Adventus, which can be downloaded from www.decon.se.

4. Adjustment of the adaptor bar

Set the wheel forward and pull up the locking lever to open the front bracket. Fit the Adventus in the middle of the footrest.

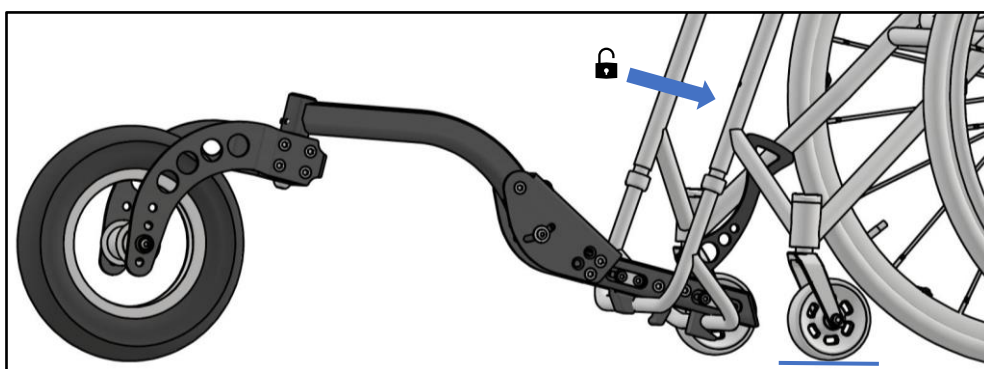

Then pull down the locking lever to secure the Adventus.

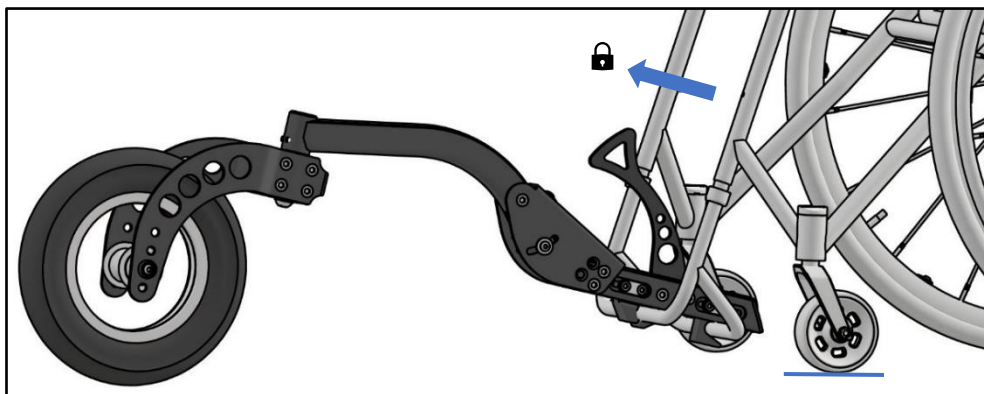

Swing the wheel backwards so that the castors are lifted off the ground.

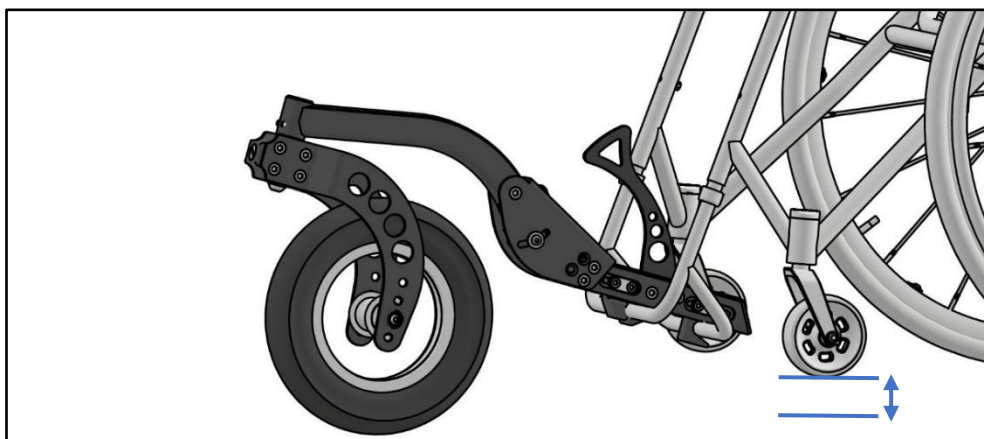

Decon Wheel AB
Södra Ekeryd 119, SE-314 93 Hyltebruk, Sweden
Tel: +46 (0)345 40880
Fax: +46 (0)345 40895
E-mail: info@decon.se

